

Rev\_08 - 20/12/2022

## COOLING UNIT FOR CONTROL BOARDS

type **PLC 5211**



COOLING UNIT FOR CONTROL BOARDS mod. **PLC 5211**

**TECHNICAL DATA SHEET**

<b>ITEM CODE</b>	<b>Plc</b>	<b>5211H31</b>	<b>5211N31</b>	<b>5211 V31</b>
<b>COOLING POWER</b>				
L35 - L35 (50 Hz) L35 - L50 (50 Hz)	W W	1.080 / 1.150 830 / 880		
<b>OPERATIVE FIELD</b>				
ENVIRONMENTAL TEMPERATURE CABINET TEMPERATURE	°C °C	20 – 55 20 – 50		
<b>VOLTAGE</b>				
RATED VOLTAGE	V / Hz	230V ~ 50-60 Hz 1~	400/460V ~ 50-60 Hz 1~	400/480V ~ 50-60 Hz 1~
<b>CURRENT</b>				
RATED CURRENT (FLA 50) STARTING CURRENT (LRA50)	A A	3,1 / 3,5 10 / 10	1,8 / 1,5 6 / 6	1,8 / 1,4 6 / 6
<b>POWER CONSUMPTION</b>				
RATED L35 - L35 (50) MAXIMUM L35 - L50 (50)	W W	520 590		
<b>REFRIGERANT</b>				
TYPE CAPACITY MAX PRESSURE	R g. kPa	134a 380 2250		
<b>PROTECTION DEGREE - EN 60529</b>				
EVAPORATOR CIRCUIT CONDENSER CIRCUIT	IP IP	55 34		
<b>AIR FLOW</b>				
EVAPORATOR CIRCUIT CONDENSER CIRCUIT	mc/h mc/h	570 860		
<b>SOUND PRESSURE</b>				
MAX	dB (A)	65		
<b>NET WEIGHT</b>				
ACCESSORI ESCLUSI	Kg	37	39	40
<b>PAINTING</b>				
STANDARD	RAL	AISI304 NOT PAINTED (painting is available on request)		
<b>OVERALL DIMENSIONS</b>				
BASE DEPTH HEIGHT	mm. mm. mm.	400 215 805		
<b>Duty cycle</b>				
		100 %		
<b>CONTROL</b>				
INCORPORATED ELECTRONIC DIGITAL THERMOSTAT		Factory setting: set =35 °C – Δt =5k		

# COOLING UNIT FOR CONTROL BOARDS mod. **PLC 5211**

## Technical description Plc 5211

- Power supply 230 V 1~ 50-60 Hz (H31 type) or 400/460V 1~ 50-60Hz (N31 type)
- Refrigerant gas R134a CFC free
- Microprocessor digital electronic thermostat with configurable delay for the output relay (prevents short intermittent cycles) and with integrated alarm functions: over range, probe fault, probe interrupted, incorrect probe connection
- Pressure switch for two-speed regulation of the condenser fan: anti-dust, anti-condensation, anti-freeze, anti-noise function
- Basket with anti-powder polyurethane filter, regenerable, on intake environ air (SIM code 050312)
- Motor-compressor and motor-driven fans equipped with thermal protector
- Condensate collection tray served by double safety drain
- Easy electrical connections through WAGO 9 poles plug and socket
- Blocking pressure switch for high pressure (optional) 1 NC contact

<b>STANDARD SUPPLY</b>	
1. Mounting Kit , consisting of:	4. flexible hose for condensate discharge
• sealing gasket,	5. Installation, Use and Maintenance Manual
• studs nuts washers,	
2. n ° 1 lifting eyebolt	6. Test certificate
3. n ° 1 Condenser inlet air filter in aluminum mesh	7. Warranty certificate

<b>OPTIONAL ACCESSORIES</b>	<b>Item code</b>
Frame to semi-recessed mounting: depth 100 mm	PAI 1021100
Frame for completely recessed installation: depth 185 mm	PAI 1021185
Replacement polyurethane filter media - to room air intake (3 pcs).	050312SP
Anti-oil regenerable aluminium mesh filter on intake environ air (1 pc)	050109

### DESCRIPTION OF THE CODE AND OF THE VARIATIONS

Serie	Model	Voltagee V	Frequency Hz	Phases ~	Paint	Kind of execution
Plc	5211	230 -- H	50-60 -- 3	Monophase -- 1	Ral 7032 – <b>01</b> Ral 9010 – <b>03</b> Ral 1014 – <b>06</b>	Standard -- <b>A</b>

### COMPLETE ORDER CODE ( es. Plc 5211H3101A)

Plc	5211	H	3	1	01	A
-----	------	---	---	---	----	---

# COOLING UNIT FOR CONTROL BOARDS mod. **PLC 5211**

## Ventilation flows:

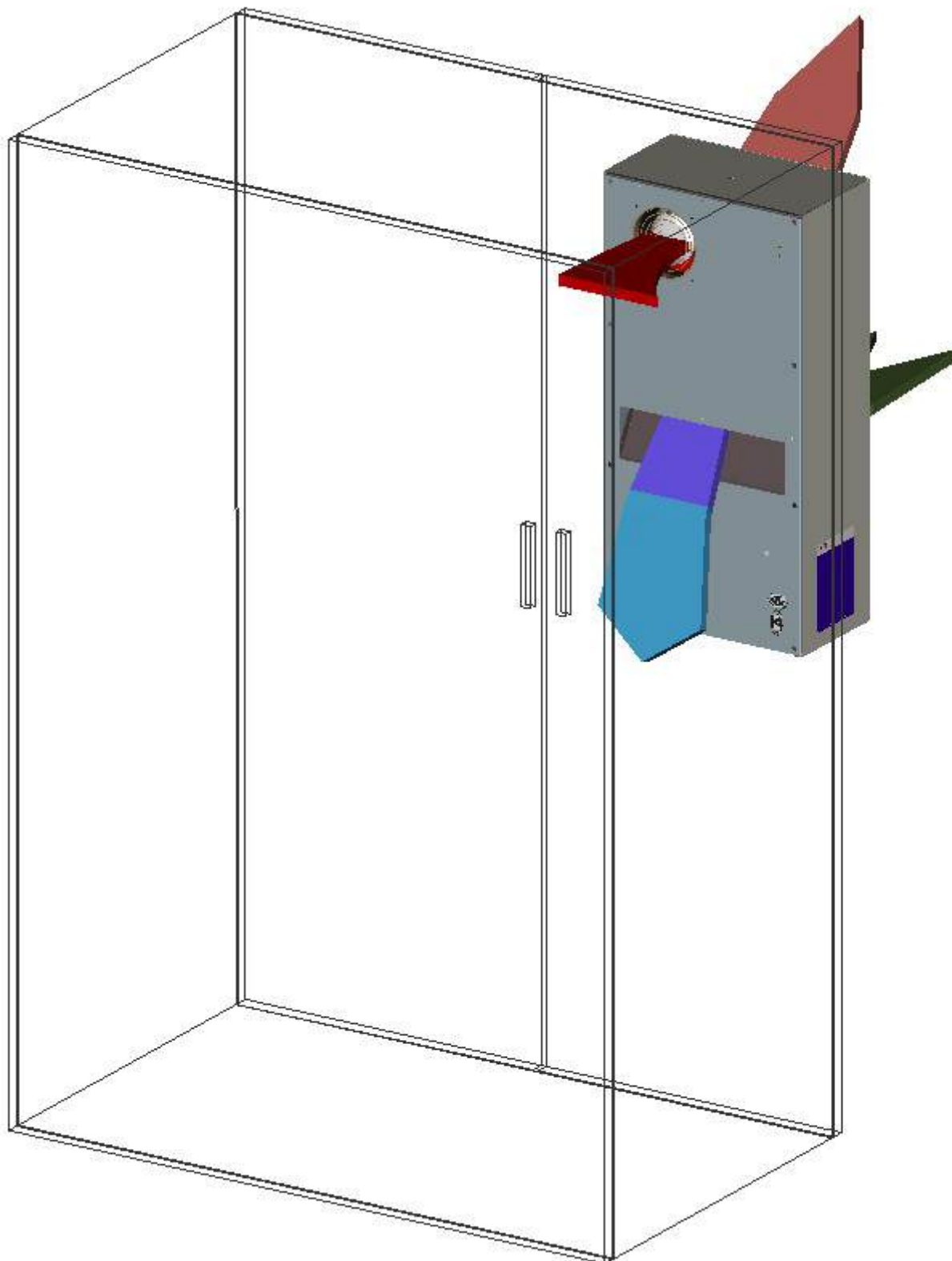

# COOLING UNIT FOR CONTROL BOARDS mod. **PLC 5211**

## Overall dimensions Plc 5211

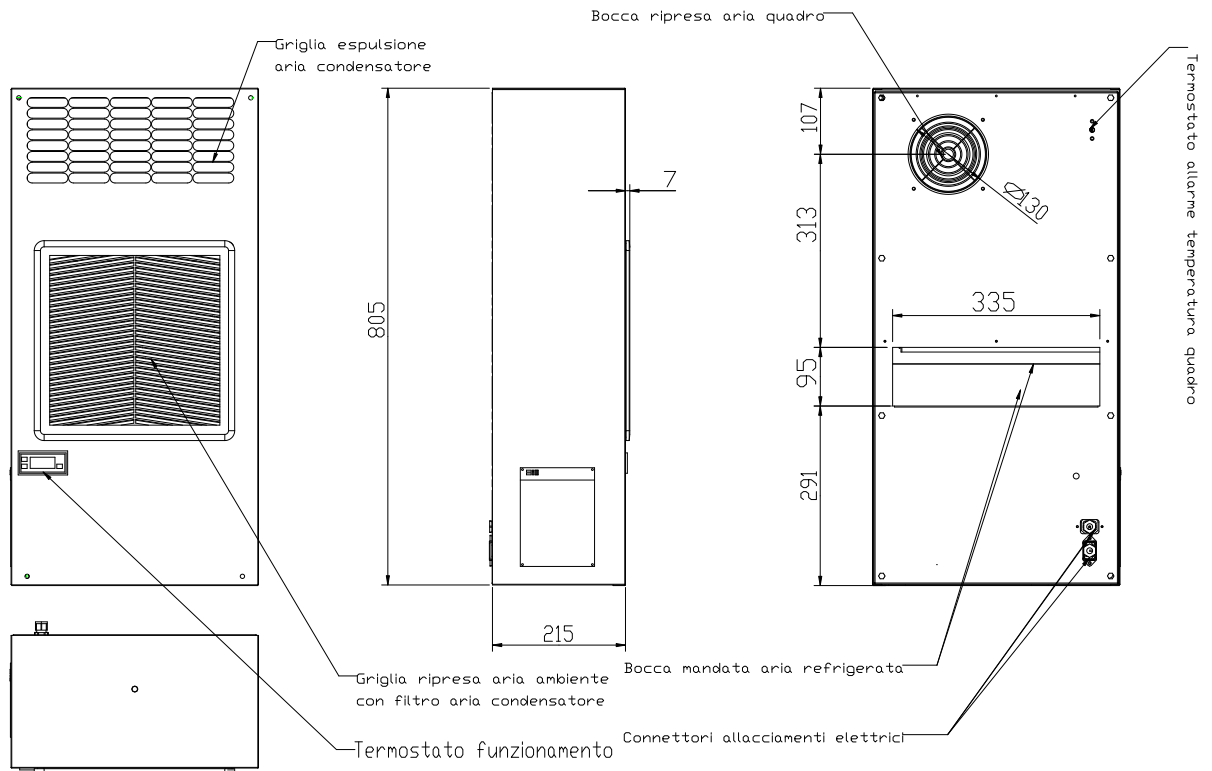

## USEFUL COOLING POWER DIAGRAM ACCORDING TO DIN 3168 (50 Hz)

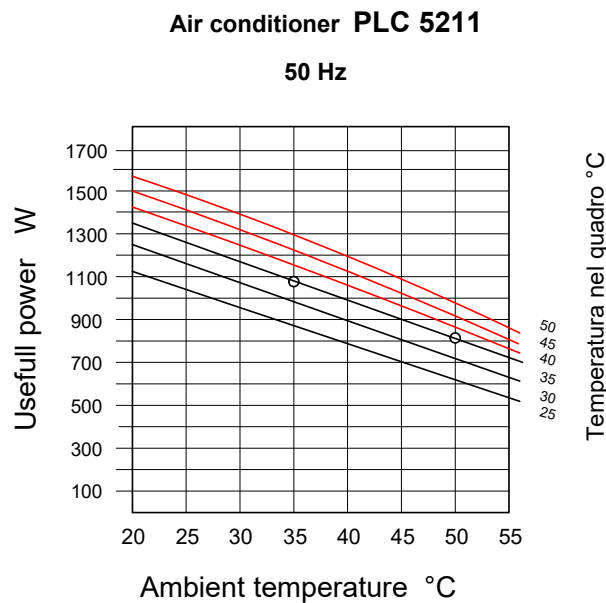

# COOLING UNIT FOR CONTROL BOARDS mod. **PLC 5211**

## Dimensions according to the type of installation

### Model **Plc 5211**

INSTALLAZION TYPE	A	B	C	D	STANDARD
STANDARD: all outside					215
Totally recessed with crankcase <b>PAI 1021185</b>			30	185	
Semirecessed with crankcase <b>PAI 1021100</b>	115	100			

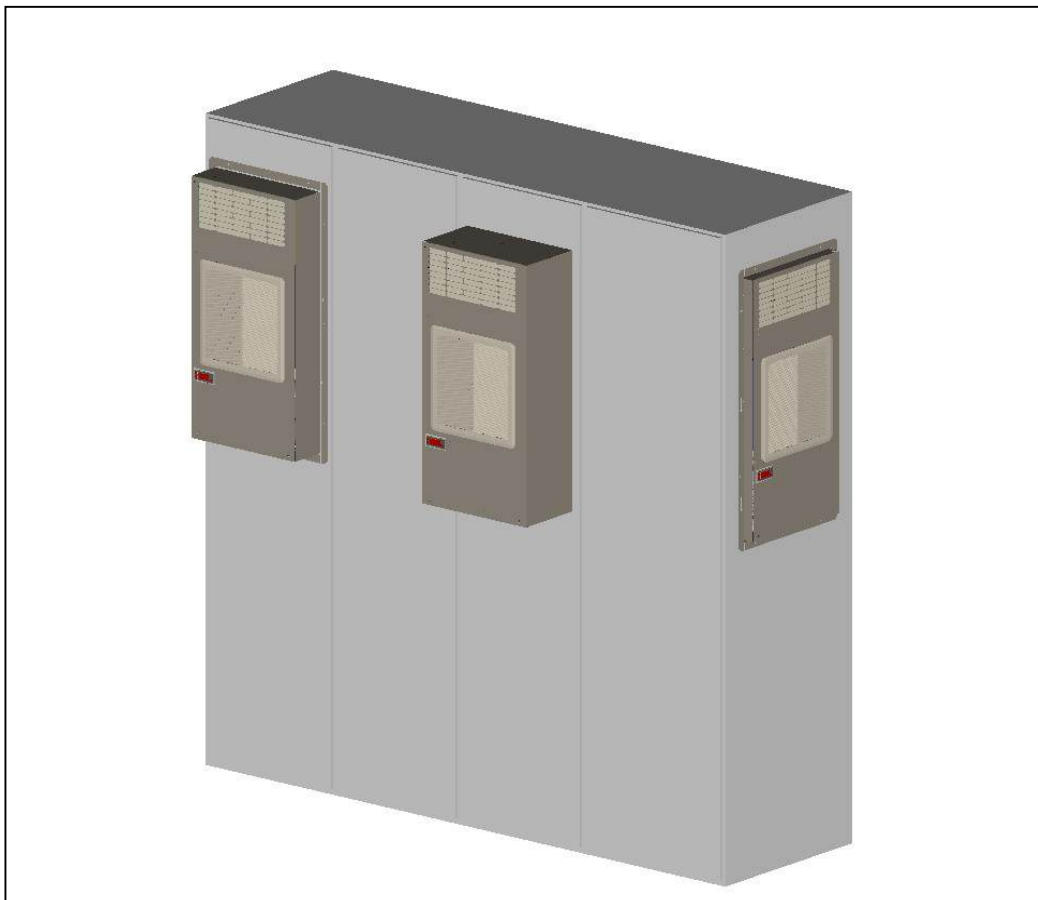
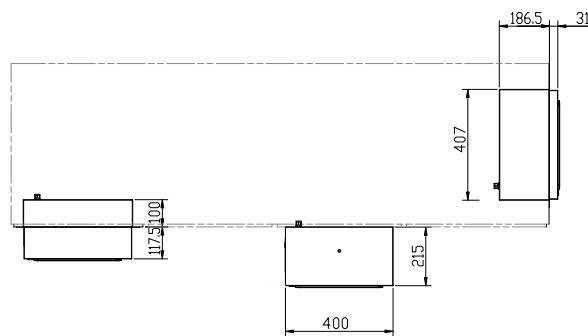

**DRILLING TEMPLATE FOR MODEL Pic 5211**

**STANDARD INSTALLATION ALL OUTSIDE**

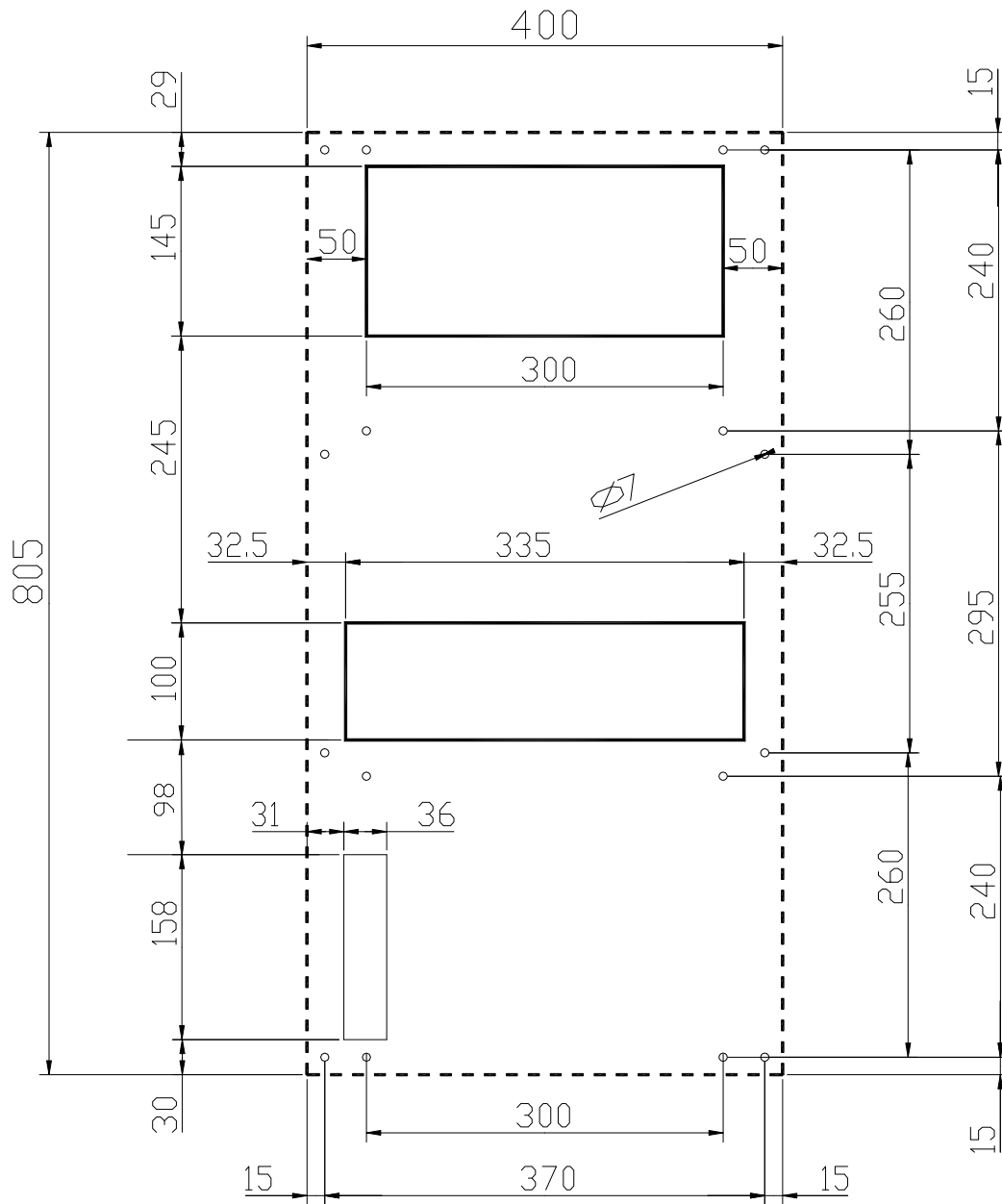

# COOLING UNIT FOR CONTROL BOARDS mod. PLC 5211

## Drilling template for recessed install PAI 1021\_050 , PAI 1021\_100, PAI 1021\_185

