

Rev 07_08 / '23

COOLING UNIT FOR CONTROL PANELS

PSC_6160 – PSC_6190



PSC_6160 - PSC_6190 Device description

- Power voltage **H_31** 230 V 1~ 50-60 Hz, **N_31** 400/460 1~ 50/60
- Refrigerant R134a without CFC
- Electronic thermostat equipped with delayable output relay (prevents short intermittent cycles) and with integrated alarm functions: over range, failed probe, interrupted probe, wrong probe connection and maximum temperature alarm
- Motocompressor and fan motors equipped by internal thermal overload protection
- Two-speed control for the condenser's fan by pressureswitch: with anti-condensation function, antifreeze, summer/winter eco mode and night silencing
- Digital Input for door position microswitch : stops cooling when opening the door
- Standard equipement provides two contacts, voltage free, to signals the Voltage absence and Cabinet's high temperature alarm; is also available, as optional only on request, one contact, voltage free, to condenser's high pressure alarm.
- Easy electrical connections through WAGO 9 poles plug and socket
- Standard painting: polyester powder RAL 7035 OP (orange peel)

STANDARD EQUIPMENT INCLUDES

| | |
|---|---|
| 1. Installation kit, that consisting: <ul style="list-style-type: none"> • sealing gasket, prisoners, nuts and washers • n ° 1 lifting eyebolt • 9 poles socket Wago X-com 500V 32A for electrical connections • flexible hose for condensate discharge | 2. Installation, Use and Maintenance Manual 3. Test certificate 4. Warranty certificate |
|---|---|

| code | OPTIONAL ACCESSORIES |
|----------------|--|
| PAF 208006 | Pressureswitch to remote signaling high pressure alarm: dirty filter alarm, condenser fan blocked or defective, room temperature beyond allowed limit. |
| P0000201 | Condensate water storage bottle, 1 liter, complete with bracket and fixing screws |
| P10239 XX | Basket with polyurethane dust filter for condenser air inlet (for RAL7035 OP, extension XX = 07) |
| P10239 XX-AL | Basket with anti oil aluminum filter for condenser air inlet (for RAL 7035 OP, extension XX = 07) |
| PAI 1023100 XX | Frame to semi-recessed mounting: depth 100 mm (for RAL 7035 OP, extension XX = 07) |
| PAI 1023180 XX | Frame for completely recessed installation: depth 180 mm (for RAL 7035 OP, extension XX = 07) |
| P0000201 | Tank of condensate storage, 1 liter, with bracket in aluminium |
| | |
| | |
| | |

VENTILATION FLOWS:

The condenser fan is equipped with a two-speed regulation with anti-dust function, anti-condensate, anti-freeze, anti-noise

The exclusive rhomboidal design of the evaporator guarantees the complete drainage of condensate and ensures an ideal, nearly vertical, delivery of the refrigerated air.

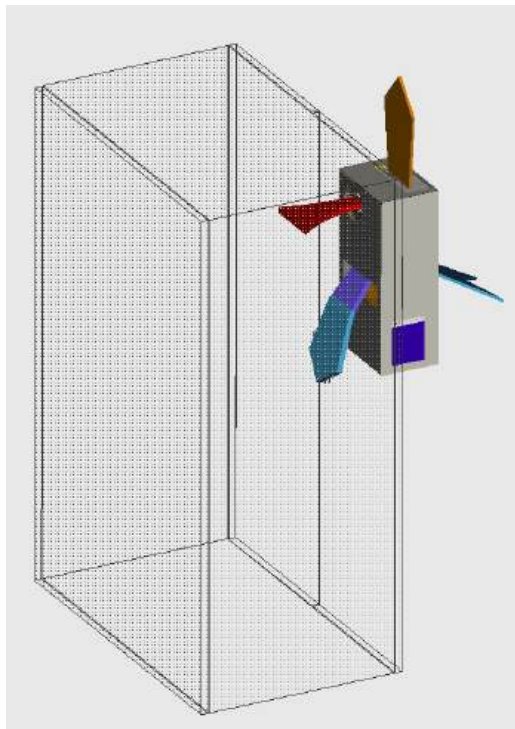

USEFUL COOLING POWER

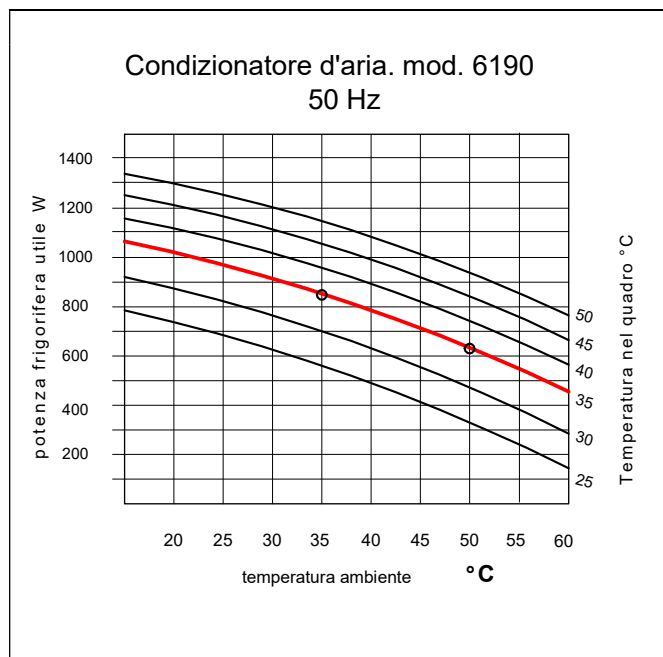
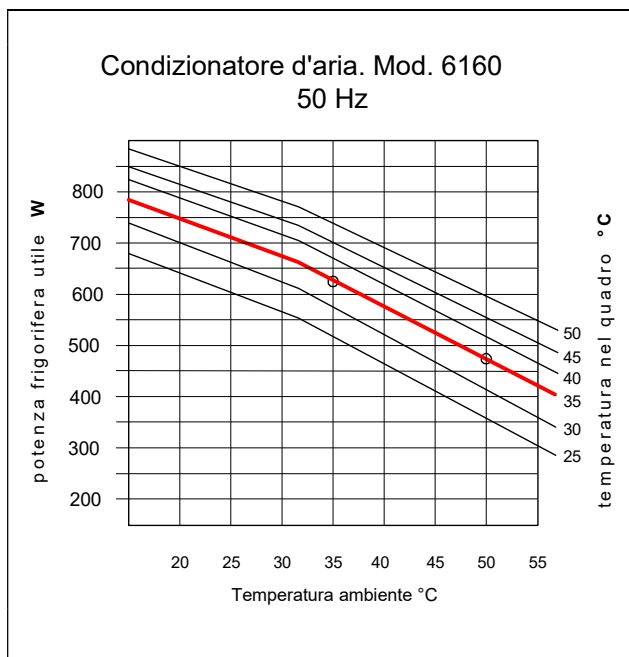

TECHNICAL FEATURES H31 VERSION
power voltage 230 V 1 ~ 50-60Hz

| ITEM CODE | PSC | 6160_H31 | 6190_H31 |
|---|------------|---|-----------------|
| Usefull cooling output - DIN3168 | | | |
| L35 - L35 (50/60) | W | 640/750 | 850/930 |
| L35 - L50 (50/60) | W | 470/520 | 640/690 |
| Operational field | | | |
| Environmental temperature | °C | 0 – 55 | |
| Cabinet temperature | °C | 20 – 50 | |
| Voltage | | | |
| Rated voltage | V / Hz | 230V~ 50- 60 Hz 1~ | |
| Current | | | |
| Rated current (50/60 FLA) | A | 1,65/1,9 | 2,2/2,7 |
| Start up current (50/60 LRA) | A | 7/8,6 | 8,5/10 |
| Power consumption | | | |
| Rated L35 - L35 (50/60) | W | 305/350 | 410/470 |
| Maximum L35 - L50 (50/60) | W | 350/410 | 490/560 |
| Refrigerant | | | |
| Type | R | 134a | 134a |
| Filling | g. | 320 | 330 |
| Admissible pressure | kPa | 2400 | 2400 |
| GWP | ----- | ----- | 1300 |
| Protection category - EN 60529 | | | |
| Cabinet side , internal circuit | IP | 54 | |
| Ambient side, external circuit | IP | 34 | |
| Fan flow, free mouth | | | |
| Cabinet side, internal circuit | mc/h | 280 | 280 |
| Ambient side, external circuit | mc/h | 570 | 860 |
| Noise level | | | |
| Maximum | dB (A) | 60 | 65 |
| Net weight | | | |
| Accessories excluded | Kg | 25 | 26 |
| Color | | | |
| Standard | RAL | 7035 orange peel (other colors available on request) | |
| Overall dimensions | | | |
| Width | mm. | 310 | |
| Depth | mm. | 220 | |
| Height | mm. | 630 | |
| Electronic controller adjustment | | | |
| Temperature setting range | °C | +20+45 Factory setting: set =35 °C – Δt =5k | |

TECHNICAL FEATURES N31 VERSION
power voltage 400/460 V 2~ 50-60Hz

| ITEM CODE | PSC | 6160 _N31 | 6190 _N31 |
|---|------------|---|------------------|
| Usefull cooling output - DIN3168 | | | |
| L35 - L35 (50/60) | W | 640/750 | 850/930 |
| L35 - L50 (50/60) | W | 470/520 | 640/690 |
| Operational field | | | |
| Environmental temperature | °C | 20 – 55 | |
| Cabinet temperature | °C | 20 – 50 | |
| Voltage | | | |
| Rated voltage | V / Hz | 400V-50 460V-60 Hz 1~ | |
| Current | | | |
| Rated current (50/60 FLA) | A | 1 / 1,1 | 1,3 / 1,6 |
| Start up current (50/60 LRA) | A | 4 / 5 | 5 / 6 |
| Power consumption | | | |
| Rated L35 - L35 (50/60) | W | 305/350 | 410/470 |
| Maximum L35 - L50 (50/60) | W | 350/410 | 490/560 |
| Refrigerant | | | |
| Type | R | 134a | 134a |
| Filling | g. | 320 | 330 |
| Admissible pressure | kPa | 2250 | 2250 |
| GWP | ----- | ----- | 1300 |
| Protection category - EN 60529 | | | |
| Cabinet side , internal circuit | IP | 54 | |
| Ambient side, external circuit | IP | 34 | |
| Fan flow, free mouth | | | |
| Cabinet side, internal circuit | mc/h | 280 | 280 |
| Ambient side, external circuit | mc/h | 570 | 860 |
| Noise level | | | |
| Maximum | dB (A) | 60 | 65 |
| Net weight | | | |
| Accessories excluded | Kg | 27 | 28 |
| Colour | | | |
| Standard | RAL | 7035 orange peel (other colors available on request) | |
| Overall dimensions | | | |
| Width | mm. | 310 | |
| Depth | mm. | 220 | |
| Height | mm. | 630 | |
| Electronic controller adjustment | | | |
| Temperature setting range | °C | 20 – 45 Factory setting: set =35 °C – Δt =5k | |

OVERALL DIMENSIONS

PSC_6160 / PSC_6190

Scarico condensa
Condensate discharge

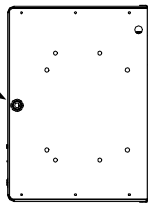

Termostato elettronico
Electronic controller

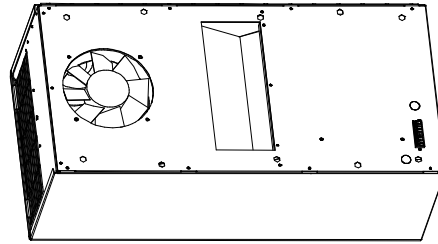
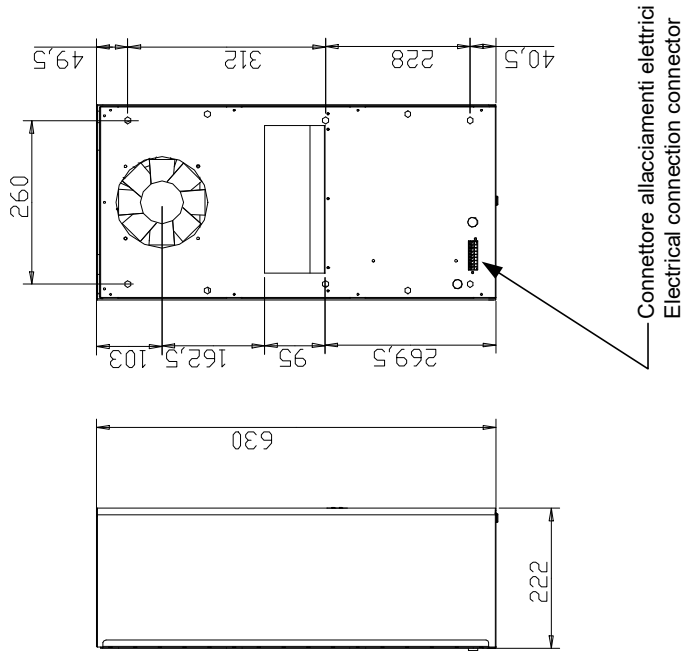
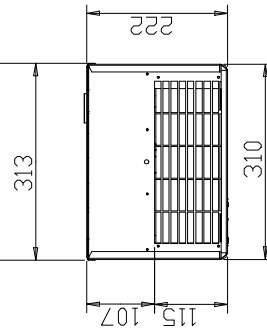
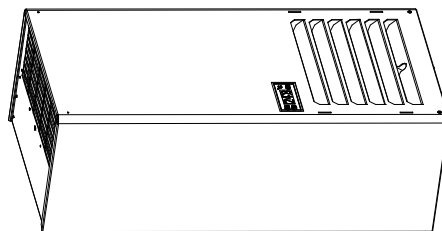
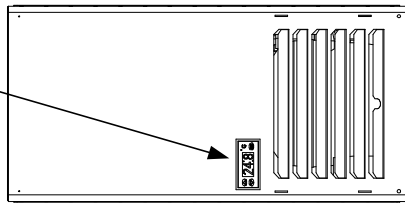

Disegno N° :
Sostituisce il N° :
Sostituito dal N° :

Fornito : A3

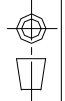

Materiale:
Spessore:
Verniciatura:

Verdello li: 26.03.2012 NDTE :
Disegnato da: ROVELLI
Approvato da:

Ingombri
Overall dimensions

S I M Engineering s.r.l.
Viale Friuli 2/F 24049 Veruello (BG)-Italy
Tel++39 035 882634-Fax++39 035 4821146

OVERALL SIZE ACCORDING TO THE TYPE OF INSTALLATION:

PSC 6160 and PSC 6190

| INSTALLATION TYPE | A | B | C | D | STANDARD |
|--|-----|-----|----|-----|----------|
| STANDARD INSTALLATION: FULLY OUTSIDE | | | | | 220 |
| FULLY INTERNAL MOUNTING WITH FRAME PAI 1023180 | | | 40 | 180 | |
| PARTIALLY INTERNAL MOUNTING WITH FRAME PAI 1023100 | 120 | 100 | | | |

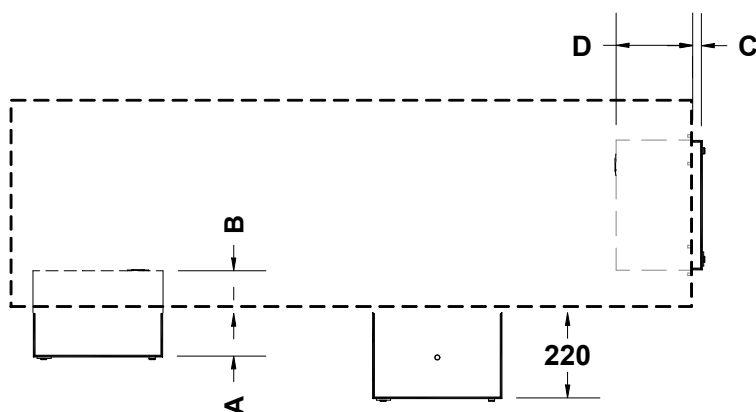

CUT-OUT AND HOLE SIZES:

Standard mounting: outside of the cabinet

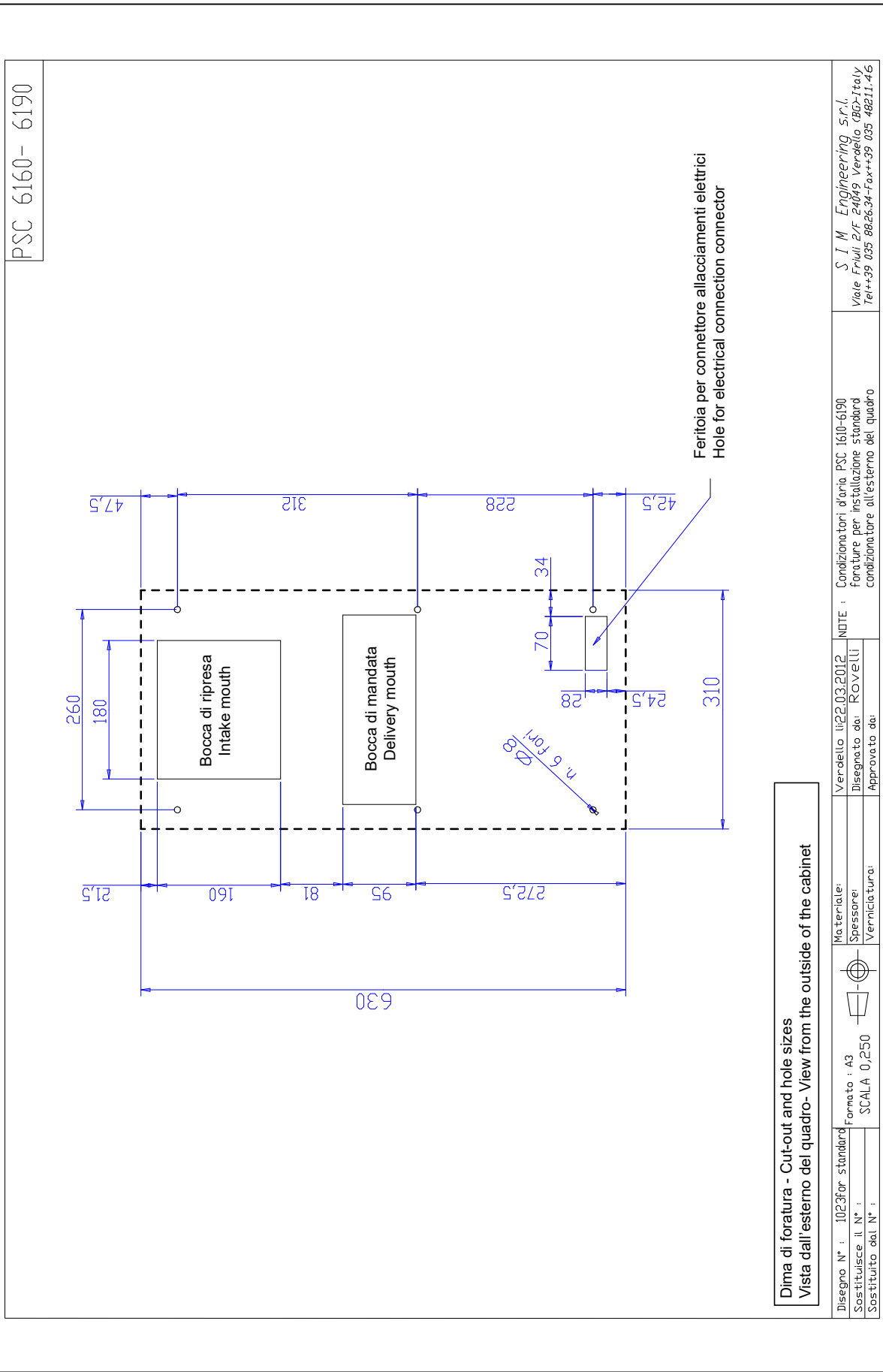

Dima di foratura - Cut-out and hole sizes
Vista dall'esterno del quadro- View from the outside of the cabinet

| | | | | | | |
|-------------------------------|--------------|---------------|-----------------------|---------------------------------------|--|--|
| Disegno N° : 1023for standard | Formato : A3 | Materiale: | Verdello li22.03.2012 | NOTE : | Condizionatori d'aria PSC 1610-6190 | S I M Engineering s.r.l. |
| Sostituisce il N° : | SCALA 0,250 | Spessore: | Disegnato da: ROVELLI | Forature per installazione standard | Viale Friuli, P.F. 24049 Verdello (BG)-Italy | Viale Friuli, P.F. 24049 Verdello (BG)-Italy |
| Sostituito dal N° : | | Verniciatura: | Approvato da: | Condizionatore all'esterno del quadro | TeI++39 035 882634-Fax++39 035 4821146 | |

Partially internal mounting: with frame PAI_1023100

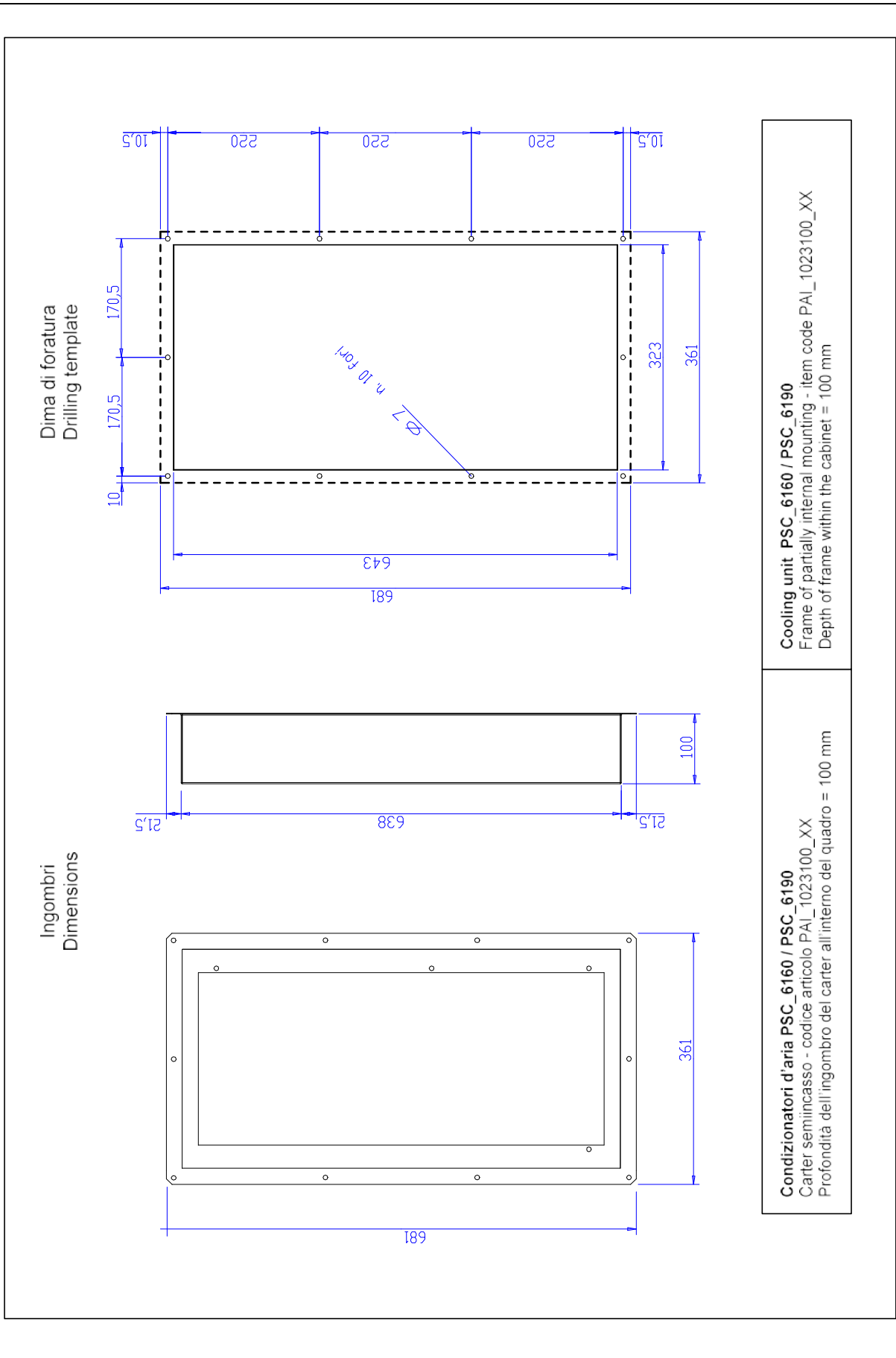

Fully internal mounting: with frame PAI_1023180

